

**PROCESSING AN AGRICULTURAL DATA STATEMENT**  
**(Pursuant to Section 305-a of the Agriculture and Markets Law)**

- Any application requiring:                    Special use permit  
                                                          Site plan approval  
                                                          Use variance or  
                                                          Subdivision approval

Which requires approval by:                A Planning Board  
                                                          Zoning Board of Appeals  
                                                          Town Board or  
                                                          Village Board of Trustees

Must submit an Agricultural Data Statement (ADS) if the proposed project occurs on property within an agricultural district containing a farm operation or on property with boundaries within 500 feet of a farm operation located within an agricultural district.

- Content of an Agricultural Data Statement requires:
  - Name and address of applicant,
  - Description of the proposed project and its location,
  - Name and address of any owner of land within the agricultural district, which land contains farm operations and is located within 500 feet of the boundaries of the property upon which the project is proposed
  - A tax map or other map showing the site of the proposed project relative to the location of the farm operations identified in the ADS.
- The Clerk of the appropriate governmental entity is required to mail a written notice containing a description of the proposed project and its location to owners of land as identified by the applicant in the ADS.
- The local reviewing board must evaluate and consider the ADS to determine the possible impacts of the proposed project may have on the functioning of farm operations within the subject agricultural district.

**Procedural Considerations**

- A map of the town's agricultural district(s) should be well displayed within the municipal office where land use applications are submitted. The map will benefit both the applicant and municipal review officer in determining the

location of the subject parcel. An Agricultural District map<sup>1</sup> can be obtained from either the County Planning Department or Clerk of the County Legislative Body.

- The local reviewing board should ascertain present and future farming conditions to ensure the proposed land use does not conflict with current or future farming activities. A farmer's knowledge of local agricultural conditions is fundamental for the local reviewing board's evaluation and determination of appropriate mitigation measures and whether the action proposed will conflict with farming practices.
- The County Agricultural and Farmland Protection Board may assist local reviewing boards in project evaluation. Members of the Board include the County Planning Directors, a County Cooperative Extension Agent and the Chair of the County Soil and Water Conservation District's Board of Directors.
- A copy of the completed ADS and action by the local reviewing board should be submitted to the County Agricultural and Farmland Protection Board for its records.

---

<sup>1</sup> Tax map identification numbers of all parcels within a district are listed and are on file at either the County Real Property Tax Office or the County Clerk's Office.

AGRICULTURAL DATA STATEMENT

1. Name and address of applicant:

Hudson Valley Wind & Solar LLC, Douglas Passeri

70 County Route 7 , Pine Plains NY 12567

2. Location of the proposed action:

49 Elsohn Rd., Ancram NY 12502 - Owner Harry Hough

3. Description of the proposed action to include: (1) Size of parcel or acreage to be acquired and tax map identification number of tax parcel(s) involved; (2) The type of action proposed (e.g., single-family dwelling or subdivision, multi-family development, apartment complex, commercial or industrial facility, school, community or public service facility, airport, etc.) and (3) project density.

**[Please provide this information on the reverse side of this application and attach additional description as necessary.]**

4. Name, address, telephone number and type of farm of owner(s) of land within the agricultural district which land contains farm operation(s) and upon which the project is proposed or which is located within 500 feet of the boundary of the property upon which the project is proposed:

A. Name: Joseph & Douglas Lozito

Address & Telephone #: 72 Elsohn Rd Ancram NY 12502

Type of farm: Farm located w/in 500' of Project - Agricultural District

B. Name: Dennis B & Claire A Sigler

Address & Telephone #: 51 Hall Hill Rd Ancram NY 12502

Type of farm: Farm located w/in 500' of Project Property - Agricultural District

C. Name: \_\_\_\_\_

Address & Telephone #: \_\_\_\_\_

Type of farm: \_\_\_\_\_

D. Name: \_\_\_\_\_

Address & Telephone #: \_\_\_\_\_

Type of farm: \_\_\_\_\_

5. Tax map or other map showing the site of the proposed project relative to the location of farm operations identified in the ADS.

## **NYS Town Law**

### **§ 283-a. Coordination with agricultural districts program.**

1. Policy of local governments. Local governments shall exercise their powers to enact local laws, ordinances, rules or regulations that apply to farm operations in an agricultural district in a manner which does not unreasonably restrict or regulate farm structures or farming practices in contravention of the purposes of article twenty-five-AA of the agriculture and markets law, unless such restrictions or regulations bear a direct relationship to the maintenance of public health or safety.
2. Agricultural data statement; submission, evaluation. Any application for a special use permit, site plan approval, use variance, or subdivision approval requiring municipal review and approval by the town board, planning board, or zoning board of appeals pursuant to this article, that would occur on property within an agricultural district containing a farm operation or on property with boundaries within five hundred feet of a farm operation located in an agricultural district, shall include an agricultural data statement. The town board, planning board, or zoning board of appeals shall evaluate and consider the agricultural data statement in its review of the possible impacts of the proposed project upon the functioning of farm operations within such agricultural district. The information required by an agricultural data statement may be included as part of any other application form required by local law, ordinance or regulation.
3. Agricultural data statement; notice provision. Upon the receipt of such application by the planning board, zoning board of appeals, or town board, the clerk of such board shall mail written notice of such application to the owners of land as identified by the applicant in the agricultural data statement. Such notice shall include a description of the proposed project and its location, and may be sent in conjunction with any other notice required by state or local law, ordinance, rule or regulation for the said project. The cost of mailing said notice shall be borne by the applicant.
4. Agricultural data statement; content. An agricultural data statement shall include the following information: the name and address of the applicant; a description of the proposed project and its location; the name and address of any owner of land within the agricultural district, which land contains farm operations and is located within five hundred feet of the boundary of the property upon which the project is proposed; and a tax map or other map showing the site of the proposed project relative to the location of farm operations identified in the agricultural data statement.
5. Notice to county planning board or agency or regional planning council. The clerk of the town board, planning board, or zoning board of appeals shall refer all applications requiring an agricultural data statement to the county planning board or agency or regional planning council as required by sections two hundred thirty-nine-m and two hundred thirty-nine-n of the general municipal law.

**Agriculture and Markets Law**  
**Article 25 AA – Agricultural Districts**

**305-a. Coordination of local planning and land use decision-making with the agricultural districts program**

1. Policy of local governments.
  - a. Local governments, when exercising their powers to enact and administer comprehensive plans and local laws, ordinances, rules or regulations, shall exercise these powers in such manner as may realize the policy and goals set forth in this article, and shall not unreasonably restrict or regulate farm operations within agricultural districts in contravention of the purposes of this article unless it can be shown that the public health or safety is threatened.
  - b. The commissioner, upon his or her own initiative or upon the receipt of a complaint from a person within an agricultural district, may bring an action to enforce the provisions of this subdivision.
2. Agricultural data statement; submission, evaluation. Any application for a special use permit, site plan approval, use variance, or subdivision approval requiring municipal review and approval by a planning board, zoning board of appeals, town board, or village board of trustees pursuant to article sixteen of the town law or article seven of the village law, that would occur on property within an agricultural district containing a farm operation or on property with boundaries within five hundred feet of a farm operation located in an agricultural district, shall include an agricultural data statement. The planning board, zoning board of appeals, town board, or village board of trustees shall evaluate and consider the agricultural data statement in its review of the possible impacts of the proposed project upon the functioning of farm operations within such agricultural district. The information required by an agricultural data statement may be included as part of any other application form required by local law, ordinance or regulation.
3. Agricultural data statement; notice provision. Upon the receipt of such application by the planning board, zoning board of appeals, town board or village board of trustees, the clerk of such board shall mail written notice of such application to the owners of land as identified by the applicant in the agricultural data statement. Such notice shall include a description of the proposed project and its location, and may be sent in conjunction with any other notice required by state or local law, ordinance, rule or regulation for the said project. The cost of mailing said notice shall be borne by the applicant.
4. Agricultural data statement; content. An agricultural data statement shall include the following information: the name and address of the applicant; a description of the proposed project and its location; the name and address of any owner of land within the agricultural district, which land contains farm operations and is located within five hundred feet of the boundary of the property upon which the project is proposed; and a tax map or other map showing the site of the proposed project relative to the location of farm operations identified in the agricultural data statement.

(circle one)

# Agricultural Data Statement

**Instructions:** This form must be completed for any application for a special use permit, site plan approval, use variance or a subdivision approval requiring municipal review that would occur on property within 500 feet of a farm operation located in a NYS Dept. of Ag & Markets certified Agricultural District.

Applicant	Owner if Different from Applicant
Name: <u>Hudson Valley Wind &amp; Solar LLC - Douglas Passeri</u>	Name: <u>Harry Hough</u>
Address: <u>70 County Route 7 Pine Plains NY 12567</u>	Address: <u>49 Elsohn Rd Ancram NY 12502</u>
_____	_____

1. Type of Application:  Special Use Permit;  Site Plan Approval ;  Use Variance;  
(circle one or more)  Subdivision Approval

2. Description of proposed project: Ground Mount PV Solar 10.08kW - Qty. 24 420W Panels / Qty. 1 SE 7.6kW HD Wave Inverter

3. Location of project: Address: 49 Elsohn Rd Ancram NY 12502  
Tax Map Number (TMP) 103400-204.-1-23.111

4. Is this parcel within an Agricultural District?  NO  YES (Check with your local assessor if

5. If YES, Agricultural District Number Columbia County 1 you do not know)

6. Is this parcel actively farmed?  NO  YES

7. List all farm operations within 500 feet of your parcel. Attach additional sheets if necessary.

Name: <u>Joseph &amp; Douglas Lozito</u>	Name: <u>Dennis B &amp; Claire A Sigler</u>
Address: <u>72 Elsohn Rs Ancram NY 12502</u>	Address: <u>51 Hall Hill Rd Ancram NY 12502</u>
<u>103400-204.-1-21</u> <u>Not Known</u>	<u>103400-205.-1-8.111</u> <u>Not Known</u>
Is this parcel actively farmed? <input type="checkbox"/> NO <input type="checkbox"/> YES	Is this parcel actively farmed? <input type="checkbox"/> NO <input type="checkbox"/> YES
Name: _____	Name: _____
Address: _____	Address: _____
Is this parcel actively farmed? <input type="checkbox"/> NO <input type="checkbox"/> YES	Is this parcel actively farmed? <input type="checkbox"/> NO <input type="checkbox"/> YES

  
Signature of Applicant

  
Signature of Owner (if other than applicant)

Reviewed by:

\_\_\_\_\_  
Signature of Municipal Official



\_\_\_\_\_  
Date

**NOTE TO REFERRAL AGENCY:** County Planning Board review is required. A copy of the Agricultural Data Statement must be submitted along with the referral to the County Planning Department.

# 49 Elshon Rd Ancram NY 12502 Harry Hough

10.08kW Grnd Mt PV Array  
Utility Service\_PV Grid Connection\_DISCO Location  
Agricultural District Properties w/in 500' Lozito\_Sigler

## Legend

-  10.08kW Grnd Mt PV
-  500' Ag
-  Utility Connection



48 Eischen Rd, Ancram, NY X

Show search results for 48 Eische



Layers: Esri, USDA FSA | Esri, HERE, Garmin, IAO, NOAA, USGS, EPA, NPS | NYS GIS Program Office | Telephone: (518) 242-3072



#1 Harry Hausen = PV.  
 #2 Joseph + Douglas Lozito = NS  
 #3 Dennis Sisk = A



# Harry Hough 49 Elsohn Rd Ancram NY 12502

103400-204.-1-23.111





1 0.08kW PV Solar Ground Mount Array

Nearest Wetland >120'

24 Mission Solar Modules

01 SolarEdge SE7600H-US 240 Inveter

## Legend

-  >120'
-  10.08kW Ground Mt. PV Solar
-  49 Elsohn Rd
-  PV Array
-  Service\_DISCO w/in 6' of TAP

10.08kW Ground Mt. PV Solar

Array Placement > 120' from Wetlands

Service\_DISCO w/in 6' of TAP



10.08kW Ground Mt PV Solar Array

Harry Hough  
49 Elsohn Rd Ancram, NY 12502  
518-329-1297  
103400.204.-1-23.111 – 21.16 Ac.

Neighbors:

- 1.) Arthur Dakin - 56 Elsohn Rd Ancram NY 12502  
103400.204.-1-18 – 1.33 Ac.
- 2.) Joseph LaMantia - 54 Elsohn Rd Ancram NY 12052  
103400.204.-1-22 – .97 Ac.
- 3.) Ronald Starkey- 44 Elsohn Rd Ancram NY 12502  
103400.204.-1-15 – 2.08 Ac.
- 4.) Barry Paradise - 32 Elsohn Rd Ancram NY 12502  
\*Mailing 70 County Route 7 Pine Plains NY 12567  
103400.204.-1-14 – .14 Ac.
- 5.) James Glomb - 7 Elsohn Rd Ancram NY 12502  
103400.204.-1-13 – 6.68 Ac.
- 6.) Douglas Ingram - 23 Wilmer Hill Rd Ancram NY 12502  
\*Mailing 6433 Somersby Dr Murrells SC 29576  
103400.204.-1-13 – 58.08 Ac.
- 7.) County of Columbia 15 N 6<sup>th</sup> Str Hudson NY 12534  
103400.204.-1-23.112 – 2.7 Ac.
- 8.) Robert Spadaccini - X Elshohn Rd Ancram NY 12502  
\*Mailing 6079 Rt. 22 Millertown NY 12546  
103400.204.-1-23.120 – 18.3 Ac
- 1.) Joseph + Douglas Lozito - Ag  
72 Elshon Rd Ancram NY 12505  
103400-204.-1-21
- 2.) Dennis B & Claire A Sigler - Ag  
51 Hall Hill Rd, Ancram Hill Rd NY 12502  
103400-205, -1-8 .111

7022 0410 0002 6352 5153

U.S. Postal Service™  
**CERTIFIED MAIL® RECEIPT**  
 Domestic Mail Only

For delivery information, visit our website at [www.usps.com](http://www.usps.com)®

**OFFICIAL USE**

Certified Mail Fee  
 \$ \_\_\_\_\_

Extra Services & Fees (check box, add fee as appropriate)

Return Receipt (hardcopy) \$ \_\_\_\_\_

Return Receipt (electronic) \$ \_\_\_\_\_

Certified Mail Restricted Delivery \$ \_\_\_\_\_

Adult Signature Required \$ \_\_\_\_\_

Adult Signature Restricted Delivery \$ \_\_\_\_\_

Postage  
 \$ \_\_\_\_\_

Total Postage and Fees  
 \$ \_\_\_\_\_

Sent To Ronald Starkzy  
 Street and Apt. No., or PO Box No.  
44 Elson Rd.  
 City, State, ZIP+4®  
Anchorage AK 99502

PS Form 3800, April 2015 PSN 7529-02-000-9017 See Reverse for Instructions

7022 0410 0002 6352 5023

U.S. Postal Service™  
**CERTIFIED MAIL® RECEIPT**  
 Domestic Mail Only

For delivery information, visit our website at [www.usps.com](http://www.usps.com)®

**OFFICIAL USE**

Certified Mail Fee  
 \$ \_\_\_\_\_

Extra Services & Fees (check box, add fee as appropriate)

Return Receipt (hardcopy) \$ \_\_\_\_\_

Return Receipt (electronic) \$ \_\_\_\_\_

Certified Mail Restricted Delivery \$ \_\_\_\_\_

Adult Signature Required \$ \_\_\_\_\_

Adult Signature Restricted Delivery \$ \_\_\_\_\_

Postage  
 \$ \_\_\_\_\_

Total Postage and Fees  
 \$ \_\_\_\_\_

Sent To Arthur Dakin  
 Street and Apt. No., or PO Box No.  
56 Elson Rd.  
 City, State, ZIP+4®  
Anchorage AK 99502

PS Form 3800, April 2015 PSN 7529-02-000-9017 See Reverse for Instructions

7022 0410 0002 6352 5054

U.S. Postal Service™  
**CERTIFIED MAIL® RECEIPT**  
 Domestic Mail Only

For delivery information, visit our website at [www.usps.com](http://www.usps.com)®

**OFFICIAL USE**

Certified Mail Fee  
 \$ \_\_\_\_\_

Extra Services & Fees (check box, add fee as appropriate)

Return Receipt (hardcopy) \$ \_\_\_\_\_

Return Receipt (electronic) \$ \_\_\_\_\_

Certified Mail Restricted Delivery \$ \_\_\_\_\_

Adult Signature Required \$ \_\_\_\_\_

Adult Signature Restricted Delivery \$ \_\_\_\_\_

Postage  
 \$ \_\_\_\_\_

Total Postage and Fees  
 \$ \_\_\_\_\_

Sent To Barry Paradise  
 Street and Apt. No., or PO Box No.  
33 Elson Rd.  
 City, State, ZIP+4®  
Anchorage AK 99502

PS Form 3800, April 2015 PSN 7529-02-000-9017 See Reverse for Instructions

7022 0410 0002 6352 5133

U.S. Postal Service™  
**CERTIFIED MAIL® RECEIPT**  
 Domestic Mail Only

For delivery information, visit our website at [www.usps.com](http://www.usps.com)®

**OFFICIAL USE**

Certified Mail Fee  
 \$ \_\_\_\_\_

Extra Services & Fees (check box, add fee as appropriate)

Return Receipt (hardcopy) \$ \_\_\_\_\_

Return Receipt (electronic) \$ \_\_\_\_\_

Certified Mail Restricted Delivery \$ \_\_\_\_\_

Adult Signature Required \$ \_\_\_\_\_

Adult Signature Restricted Delivery \$ \_\_\_\_\_

Postage  
 \$ \_\_\_\_\_

Total Postage and Fees  
 \$ \_\_\_\_\_

Sent To Joseph LaMantia  
 Street and Apt. No., or PO Box No.  
54 Elson Rd.  
 City, State, ZIP+4®  
Anchorage AK 99502

PS Form 3800, April 2015 PSN 7529-02-000-9017 See Reverse for Instructions

7022 0410 0002 6352 5061

U.S. Postal Service™  
**CERTIFIED MAIL® RECEIPT**  
 Domestic Mail Only

For delivery information, visit our website at [www.usps.com](http://www.usps.com)®

**OFFICIAL USE**

Certified Mail Fee  
 \$ \_\_\_\_\_

Extra Services & Fees (check box, add fee as appropriate)

Return Receipt (hardcopy) \$ \_\_\_\_\_

Return Receipt (electronic) \$ \_\_\_\_\_

Certified Mail Restricted Delivery \$ \_\_\_\_\_

Adult Signature Required \$ \_\_\_\_\_

Adult Signature Restricted Delivery \$ \_\_\_\_\_

Postage  
 \$ \_\_\_\_\_

Total Postage and Fees  
 \$ \_\_\_\_\_

Sent To James Glomb  
 Street and Apt. No., or PO Box No.  
7 Elson Rd.  
 City, State, ZIP+4®  
Anchorage AK 99502

PS Form 3800, April 2015 PSN 7529-02-000-9017 See Reverse for Instructions

7022 0410 0002 6352 5122

**U.S. Postal Service™  
CERTIFIED MAIL® RECEIPT**  
Domestic Mail Only

For delivery information, visit our website at [www.usps.com](http://www.usps.com)™.

**OFFICIAL USE**

Certified Mail Fee \$	Postmark Here
Extra Services & Fees (check box, add fee as appropriate)	
Postage \$	
Total Postage and Fees \$	
Sent To Dennis B Sigler Street and Apt. No., or PO Box No. St Hall Hill Rd. City, State, ZIP+4® Ancrum NY 12502	

PS Form 3800, April 2015 PSN 7502-0000-0047 See Reverse for Instructions

7022 0410 0002 6352 5146

**U.S. Postal Service™  
CERTIFIED MAIL® RECEIPT**  
Domestic Mail Only

For delivery information, visit our website at [www.usps.com](http://www.usps.com)™.

**OFFICIAL USE**

Certified Mail Fee \$	Postmark Here
Extra Services & Fees (check box, add fee as appropriate)	
Postage \$	
Total Postage and Fees \$	
Sent To Joseph & Douglas Lozito Street and Apt. No., or PO Box No. 72 Elsohn Rd. City, State, ZIP+4® Ancrum NY 12502	

PS Form 3800, April 2015 PSN 7502-0000-0047 See Reverse for Instructions

7022 0410 0002 6352 5065

**U.S. Postal Service™  
CERTIFIED MAIL® RECEIPT**  
Domestic Mail Only

For delivery information, visit our website at [www.usps.com](http://www.usps.com)™.

**OFFICIAL USE**

Certified Mail Fee \$	Postmark Here
Extra Services & Fees (check box, add fee as appropriate)	
Postage \$	
Total Postage and Fees \$	
Sent To County of Columbia NY Street and Apt. No., or PO Box No. 15 W 4th Str. City, State, ZIP+4® Newtown NY 12534	

PS Form 3800, April 2015 PSN 7502-0000-0047 See Reverse for Instructions

7022 0410 0002 6352 5092

**U.S. Postal Service™  
CERTIFIED MAIL® RECEIPT**  
Domestic Mail Only

For delivery information, visit our website at [www.usps.com](http://www.usps.com)™.

**OFFICIAL USE**

Certified Mail Fee \$	Postmark Here
Extra Services & Fees (check box, add fee as appropriate)	
Postage \$	
Total Postage and Fees \$	
Sent To Robert Spadaccini Street and Apt. No., or PO Box No. 607 Rt 22 City, State, ZIP+4® Newtown NY 12540	

PS Form 3800, April 2015 PSN 7502-0000-0047 See Reverse for Instructions

7022 0410 0002 6352 5078

**U.S. Postal Service™  
CERTIFIED MAIL® RECEIPT**  
Domestic Mail Only

For delivery information, visit our website at [www.usps.com](http://www.usps.com)™.

**OFFICIAL USE**

Certified Mail Fee \$	Postmark Here
Extra Services & Fees (check box, add fee as appropriate)	
Postage \$	
Total Postage and Fees \$	
Sent To Douglas Ingram Street and Apt. No., or PO Box No. 6435 Somerset Dr.	

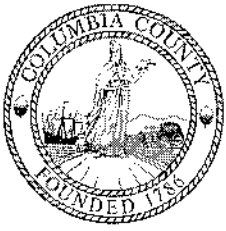

Columbia County, New York  
**Planning Board**

*VIA EMAIL ONLY*

20 September 2022

Mr. Terry Porter, Chairman  
Town of Gallatin Planning Board  
P.O. Box 67  
Ancram, NY 12502  
tbp@porterclapp.com

RE: Referral #22-051 – Harry Hough, Special Use Permit and Site Plan Review

Dear Chairman Porter:

Pursuant to the provisions of New York State General Municipal Law (NYSGL) §239-1 and §239-m, please find the Columbia County Planning Board (CCPB) recommendation concerning the request of the Harry Hough for a Special Use Permit and Site Plan Review. The proposed action is to construct a ground mounted solar array. The site is located at the corner of Elsohn Road and NY State Route 82 in the Town of Gallatin, NY.

Pursuant to NYSGL §239-1 and §239-m, the CCPB reviews proposed actions for inter-community or county-wide considerations and shall recommend Approval, Modification or Disapproval of the proposed action, or report that the proposed action has no significant county-wide or intercommunity impact. Upon recommendation of Modification or Disapproval, "...the referring body shall not act contrary to such recommendation except by a vote of majority plus one of all the members thereof". The CCPB may make informal comments to the referring body on the proposed action with any of the recommendations made.

Recommendation: The CCPB finds that this proposed action has no significant county-wide or intercommunity impacts associated with it. Therefore, the Town of Gallatin Planning Board may take final action with a simple majority vote. However, the following informal comments are offered for consideration:

Comments:

1. Utility Connection: The CCPB suggests that the applicant provide information on any proposed connection to the existing utility grid, including the locations of utility poles, underground lines, etc. on the site plan.
2. Solar Array: The CCPB suggests that the applicant provide detailed information on the proposed solar array, which may include plans, details, specifications and array material finish to minimize glare.

3. Emergency Access: The CCPB suggests that the local Fire Chief review the site plan.
4. Agricultural District: Pursuant to §305-a of the New York State Agricultural and Markets Law, any application for a special use permit, site plan approval, use variance, or subdivision approval requiring municipal review and approval that would occur on property within a NYS Certified Agricultural District containing a farm operation or property with boundaries within 500 feet of a farm operation located in an Agricultural District shall include an Agricultural Data Statement. The CCPB notes that an Agricultural Data Statement may be required as the following parcel is located in Columbia County Agricultural District No. 1 (CCAD#1): 205.-1-8.111, owned, or formerly owned by Dennis Sigler.
5. Wetlands: The CCPB notes the presence of Federal wetlands on this parcel. Any proposed disturbance of the wetlands may require permitting by the United States Army Corp of Engineers (USACE).

Please note that within thirty (30) days after final action is taken, the Town of Gallatin Planning Board shall file a report of the final action it has taken with the CCPB. For additional information please contact Columbia County Planning Department at 518.828.3375 or [patrice.perry@columbiacountyny.com](mailto:patrice.perry@columbiacountyny.com)

Sincerely yours,



Timothy Stalker  
Chair

NOTES: 1) PREMISES SURVEYED IS DESCRIBED IN LIBER 602 PAGE 597 ON FILE IN THE OFFICE OF THE COLUMBIA COUNTY CLERK.  
 2) ROADLINES ARE IN ACCORDANCE WITH MICRO #2776.

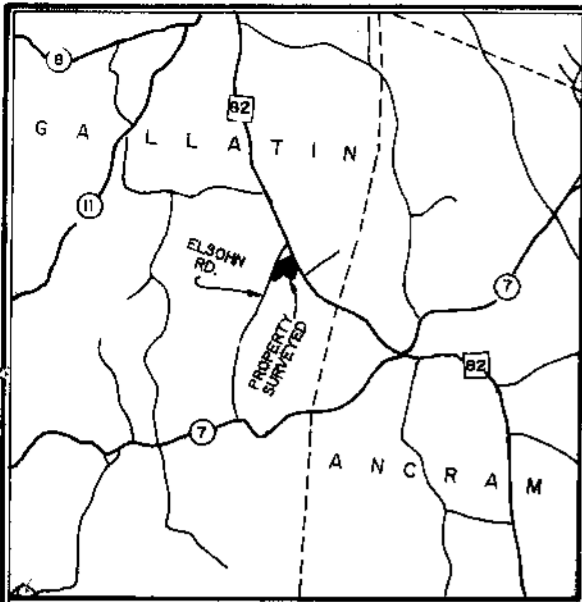

LOCATION SKETCH

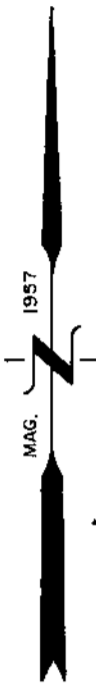

PETER C. & REGINA ANN JAWORSKI L-567 P-554

N.Y.S. Route 82

21.16 Acres

ELSOHN RD.

TOWN RD.

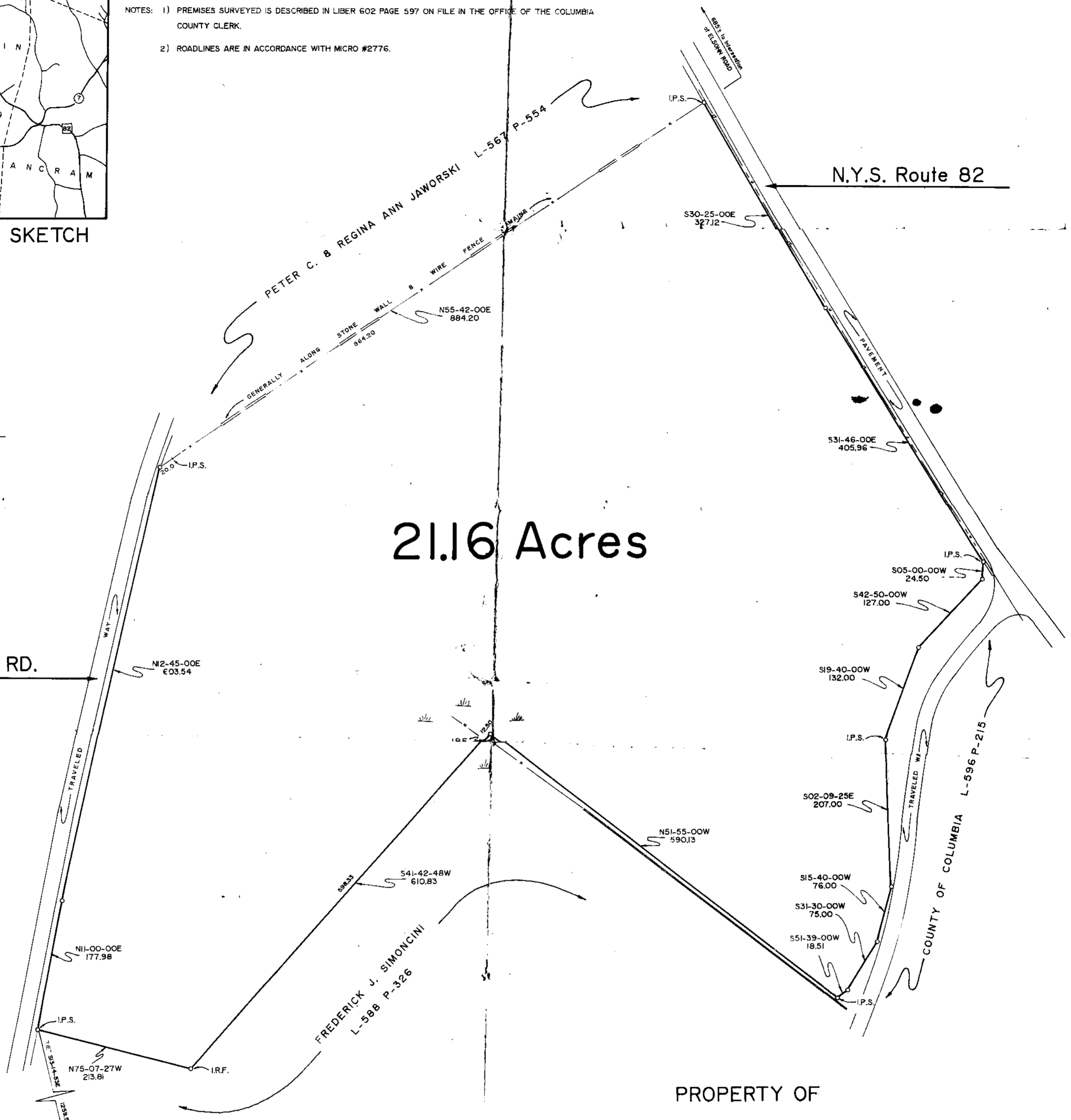

LEGEND

- I.P.S. DENOTES IRON PIPE SET
- I.R.F. " IRON ROD FOUND
- ===== " STONE WALL
- " OVERHEAD UTILITIES
- " NO PHYSICAL BOUNDS
- " WIRE FENCE

PROPERTY OF

EDWARD HOUGH

AND

ROBIN HOUGH

TOWN OF GALLATIN, COLUMBIA COUNTY, NEW YORK

*Philip J. Massaro*  
 N.Y.S.L.S. #049478

SURVEY BY:  
 PHILIP J. MASSARO  
 BOX 236J ELIZAVILLE, N.Y.

SCALE: 1" = 100'  
 6 AUGUST 1987

UNAUTHORIZED ALTERATION OR ADDITION TO THIS DRAWING IS A VIOLATION OF SECTION 7209, SUBDIVISION 2 OF THE NEW YORK STATE EDUCATION LAW. COPIES OF THIS DRAWING ARE VALID ONLY IF THEY BEAR THE IMPRESSED SEAL OF THE PREPARER.

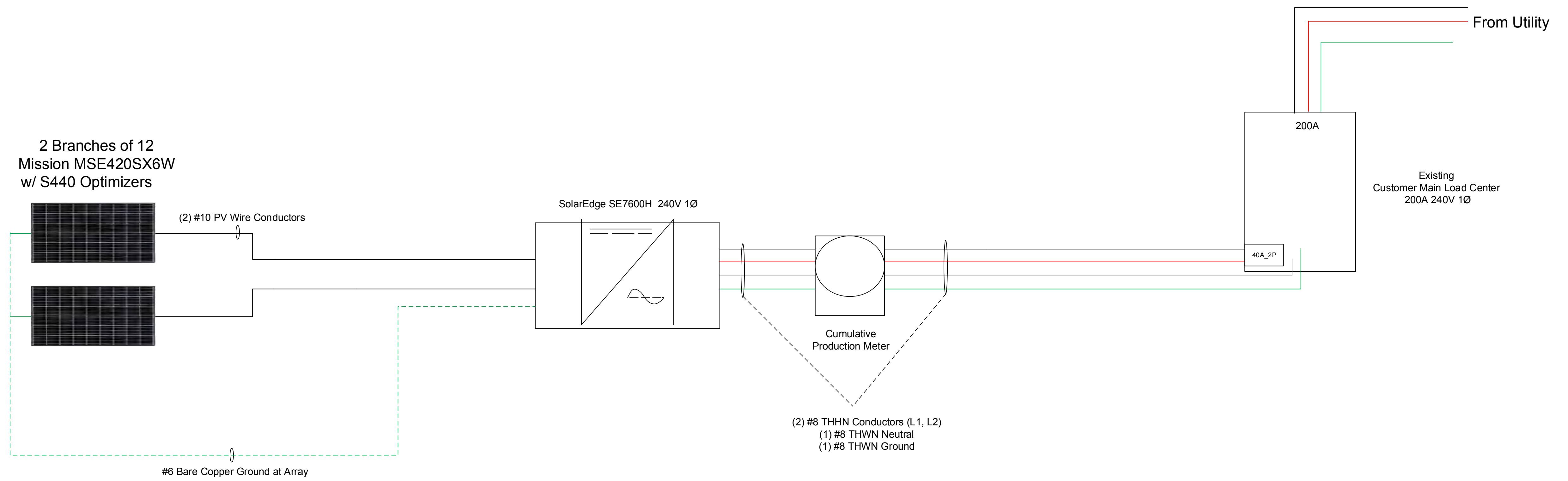

Harry Hough  
49 Elschon Rd.  
Ancram, NY 12502

10.08kW Ground Mount  
(24) Mission MSE420SX6W  
(24) SolarEdge S440 Optimizers  
(1) SolarEdge SE7600H 240V Inverter

SIZE	FSCM NO	DWGN NO	REV
Not to Scale		SHEET	1 OF 1

Drawn by Conor Keys





# 420W

Class leading power output

Positive Power Tolerance

-0 to +3%

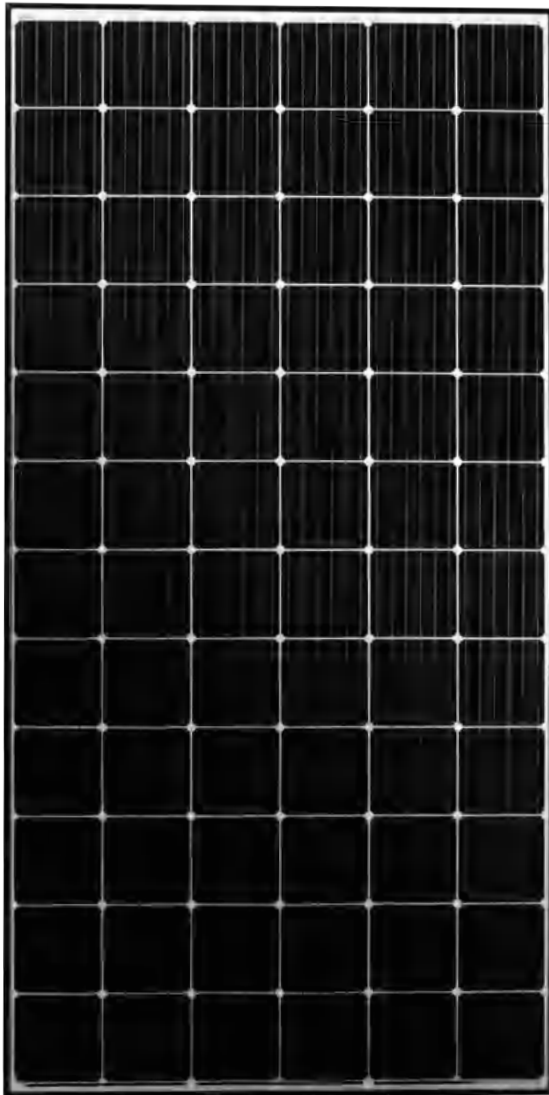

## True American Quality True American Brand

Mission Solar Energy is headquartered in San Antonio, Texas where we manufacture our modules. We produce American, high-quality solar modules ensuring the highest-in-class power output and best-in-class reliability. Our product line is tailored for residential, commercial and utility applications. Every Mission Solar Energy solar module is certified and surpasses industry standard regulations, proving excellent performance over the long term.

**Demand the best. Demand Mission Solar Energy.**



### Certified Reliability

- Tested to UL 61730 & IEC Standards
- PID resistant
- Resistance to salt mist corrosion



### Advanced Technology

- 6 Busbar
- Passivated Emitter Rear Contact
- Ideal for all applications



### Extreme Weather Resilience

- Up to 5,400 Pa front load & 3,600 Pa back load
- Tested load to UL 61730
- 40 mm frame



### BAA Compliant for Government Projects

- Buy American Act
- American Recovery & Reinvestment Act

### FRAME-TO-FRAME WARRANTY

Degradation guaranteed not to exceed 2% in year one and 0.58% annually from years two to 30 with 84.08% capacity guaranteed in year 25.

For more information, visit [www.missionsolar.com/warranty](http://www.missionsolar.com/warranty)

### CERTIFICATIONS

CEC



If you have questions or concerns about certification of our products in your area, please contact Mission Solar Energy.

UL 61730 / IEC 61215 / IEC 61730 / IEC 61701

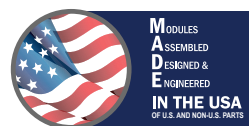

## BASIC DIMENSIONS

[UNITS: MM/IN]

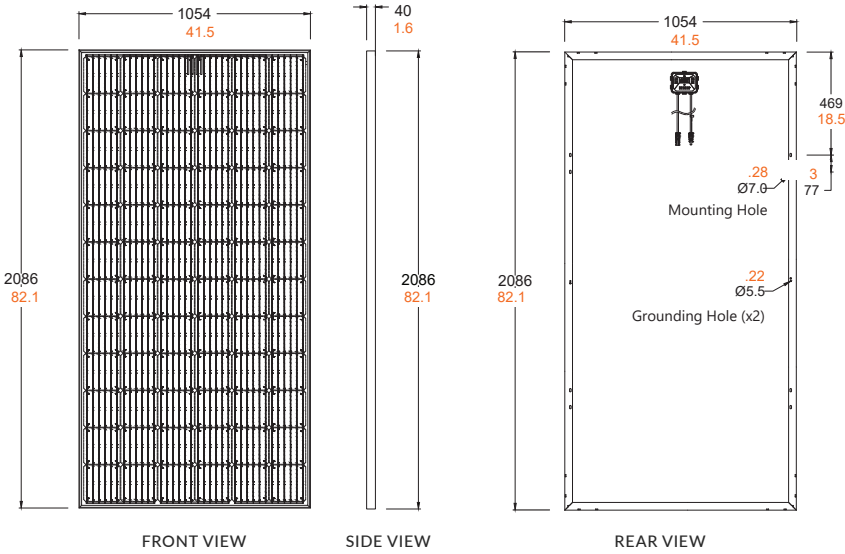

## ELECTRICAL SPECIFICATION

PRODUCT TYPE	MSE <sub>xxx</sub> SX6W (xxx = P <sub>max</sub> )				
Power Output	P <sub>max</sub>	W <sub>p</sub>	415	420	425
Module Efficiency	%		18.9	19.1	19.3
Tolerance	%		0/+3	0/+3	0/+3
Short Circuit Current	I <sub>sc</sub>	A	10.99	11.05	11.09
Open Circuit Voltage	V <sub>oc</sub>	V	48.92	49.14	49.28
Rated Current	I <sub>mp</sub>	A	10.39	10.46	10.55
Rated Voltage	V <sub>mp</sub>	V	39.93	40.14	40.27
Fuse Rating	A		20	20	20
System Voltage	V		1,500	1,500	1,500

## TEMPERATURE COEFFICIENTS

Normal Operating Cell Temperature (NOCT)	44.69°C (±3.7%)
Temperature Coefficient of P <sub>max</sub>	-0.359%/°C
Temperature Coefficient of V <sub>oc</sub>	-0.261%/°C
Temperature Coefficient of I <sub>sc</sub>	0.044%/°C

## CURRENT-VOLTAGE CURVE

MSE415SX6W: 415WP, 72 CELL SOLAR MODULE

Current-voltage characteristics with dependence on irradiance and module temperature

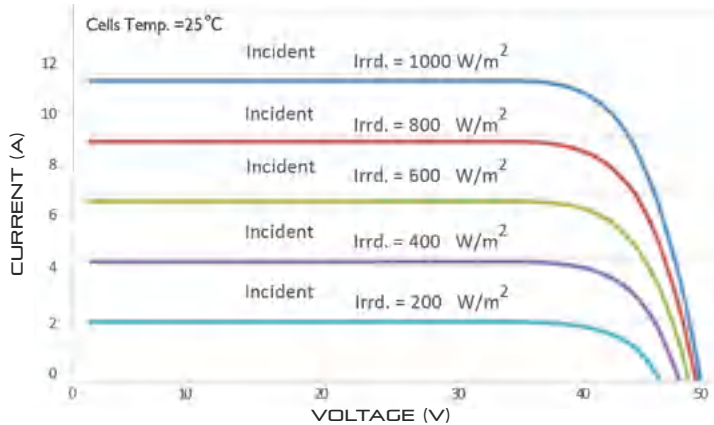

## OPERATING CONDITIONS

Maximum System Voltage	1,500Vdc
Operating Temperature Range	-40°C (-40°F) to +85°C (185°F)
Maximum Series Fuse Rating	20A
Fire Safety Classification	Type 1
Front & Back Load (UL Standard)	Up to 5400 Pa front and 3600 Pa back load, Tested to UL 61730
Hail Safety Impact Velocity	25mm at 23 m/s

## MECHANICAL DATA

Solar Cells	P-type mono-crystalline silicon
Cell Orientation	72 cells (6x12)
Module Dimension	2,086mm x 1,054mm x 40mm
Weight	23.4 kg (51.6 lbs.)
Front Glass	3.2mm, tempered, low-iron, anti-reflective
Frame	Anodized
Encapsulant	Ethylene vinyl acetate (EVA)
Junction Box	Protection class IP67 with 3 bypass-diodes
Cable	1.2m, Wire 4mm <sup>2</sup> (12AWG)
Connector	Staubli PV-KBT4/6II-UR and PV-KST4/6II-UR, MC4, Renhe 05-8

## CERTIFICATIONS AND TESTS

IEC	61215, 61730, 61701
UL	61730



CEC



## Mission Solar Energy

8303 S. New Braunfels Ave., San Antonio, Texas 78235  
www.missionsolar.com | info@missionsolar.com

## SHIPPING INFORMATION

Container Feet	Ship To	Pallet	Panels	415 W Bin
53'	Most States	28	728	305.76 kW
Double Stack	CA	25	650	273 kW

## PALLET [26 PANELS]

Weight	Height	Width	Length
1,450 lbs. (657 kg)	47.5 in (120.65 cm)	46 in (116.84 cm)	83.75 in (212.72 cm)

# Single Phase Inverter with HD-Wave Technology

for North America

SE3000H-US / SE3800H-US / SE5000H-US / SE6000H-US /  
SE7600H-US / SE10000H-US / SE11400H-US



## Optimized installation with HD-Wave technology

- Specifically designed to work with power optimizers
- Record-breaking efficiency
- Quick and easy inverter commissioning directly from a smartphone using the SolarEdge SetApp
- Fixed voltage inverter for longer strings
- Integrated arc fault protection and rapid shutdown for NEC 2014 and 2017, per article 690.11 and 690.12
- UL1741 SA certified, for CPUC Rule 21 grid compliance
- Extremely small
- Built-in module-level monitoring
- Outdoor and indoor installation
- Optional: Revenue grade data, ANSI C12.20 Class 0.5 (0.5% accuracy)

# / Single Phase Inverter with HD-Wave Technology for North America

SE3000H-US / SE3800H-US / SE5000H-US / SE6000H-US/  
SE7600H-US / SE10000H-US / SE11400H-US

	SE3000H-US	SE3800H-US	SE5000H-US	SE6000H-US	SE7600H-US	SE10000H-US	SE11400H-US	
APPLICABLE TO INVERTERS WITH PART NUMBER	SEXXXXH-XXXXXBXX4							
<b>OUTPUT</b>								
Rated AC Power Output	3000	3800 @ 240V 3300 @ 208V	5000	6000 @ 240V 5000 @ 208V	7600	10000	11400 @ 240V 10000 @ 208V	VA
Maximum AC Power Output	3000	3800 @ 240V 3300 @ 208V	5000	6000 @ 240V 5000 @ 208V	7600	10000	11400 @ 240V 10000 @ 208V	VA
AC Output Voltage Min.-Nom.-Max. (211 - 240 - 264)	✓	✓	✓	✓	✓	✓	✓	Vac
AC Output Voltage Min.-Nom.-Max. (183 - 208 - 229)	-	✓	-	✓	-	-	✓	Vac
AC Frequency (Nominal)	59.3 - 60 - 60.5 <sup>(1)</sup>							Hz
Maximum Continuous Output Current @240V	12.5	16	21	25	32	42	47.5	A
Maximum Continuous Output Current @208V	-	16	-	24	-	-	48.5	A
Power Factor	1, adjustable -0.85 to 0.85							
GFDI Threshold	1							A
Utility Monitoring, Islanding Protection, Country Configurable Thresholds	Yes							
<b>INPUT</b>								
Maximum DC Power @240V	4650	5900	7750	9300	11800	15500	17650	W
Maximum DC Power @208V	-	5100	-	7750	-	-	15500	W
Transformer-less, Ungrounded	Yes							
Maximum Input Voltage	480							Vdc
Nominal DC Input Voltage	380				400			Vdc
Maximum Input Current @240V <sup>(2)</sup>	8.5	10.5	13.5	16.5	20	27	30.5	Adc
Maximum Input Current @208V <sup>(2)</sup>	-	9	-	13.5	-	-	27	Adc
Max. Input Short Circuit Current	45							Adc
Reverse-Polarity Protection	Yes							
Ground-Fault Isolation Detection	600k $\Omega$ Sensitivity							
Maximum Inverter Efficiency	99	99.2						%
CEC Weighted Efficiency	99						99 @ 240V 98.5 @ 208V	%
Nighttime Power Consumption	< 2.5							W

<sup>(1)</sup> For other regional settings please contact SolarEdge support

<sup>(2)</sup> A higher current source may be used; the inverter will limit its input current to the values stated

# / Single Phase Inverter with HD-Wave Technology for North America

SE3000H-US / SE3800H-US / SE5000H-US / SE6000H-US/  
SE7600H-US / SE10000H-US / SE11400H-US

SE3000H-US SE3800H-US SE5000H-US SE6000H-US **SE7600H-US** SE10000H-US SE11400H-US

## ADDITIONAL FEATURES

Supported Communication Interfaces	RS485, Ethernet, ZigBee (optional), Cellular (optional)
Revenue Grade Data, ANSI C12.20	Optional <sup>(3)</sup>
Inverter Commissioning	with the SetApp mobile application using built-in Wi-Fi station for local connection
Rapid Shutdown - NEC 2014 and 2017 690.12	Automatic Rapid Shutdown upon AC Grid Disconnect

## STANDARD COMPLIANCE

Safety	UL1741, UL1741 SA, UL1699B, CSA C22.2, Canadian AFCI according to T.I.L. M-07
Grid Connection Standards	IEEE1547, Rule 21, Rule 14 (HI)
Emissions	FCC Part 15 Class B

## INSTALLATION SPECIFICATIONS

AC Output Conduit Size / AWG Range	3/4" minimum / 14-6 AWG			3/4" minimum /14-4 AWG	
DC Input Conduit Size / # of Strings / AWG Range	3/4" minimum / 1-2 strings / 14-6 AWG			3/4" minimum / 1-3 strings / 14-6 AWG	
Dimensions with Safety Switch (HxWxD)	17.7 x 14.6 x 6.8 / 450 x 370 x 174			21.3 x 14.6 x 7.3 / 540 x 370 x 185	in / mm
Weight with Safety Switch	22 / 10	25.1 / 11.4	26.2 / 11.9	38.8 / 17.6	lb / kg
Noise	< 25			<50	dBA
Cooling	Natural Convection				
Operating Temperature Range	-40 to +140 / -40 to +60 <sup>(4)</sup>				
Protection Rating	NEMA 4X (Inverter with Safety Switch)				

<sup>(3)</sup> Revenue grade inverter P/N: SExxxxH-US000BNC4

<sup>(4)</sup> Full power up to at least 50°C / 122°F; for power de-rating information refer to: <https://www.solaredge.com/sites/default/files/se-temperature-derating-note-na.pdf>

## Harry Hough 49 Elsohn Rd Ancram NY 12502

Project Details			
<b>Name</b>	HVWE - 10.08kW GM	<b>Date</b>	05/09/2022
<b>Location</b>	Pine Plains, NY 12567	<b>ASCE code</b>	7.10
<b>Total modules</b>	24	<b>Wind speed</b>	100 mph
<b>Module</b>	Mission Solar Energy: MSE420SX6W (40mm)	<b>Snow load</b>	40 psf
<b>Dimensions</b>	Dimensions: 82.13" x 41.5" x 1.57" (2086.0mm x 1054.0mm x 40.0mm)	<b>Wind exposure</b>	B
<b>Total watts</b>	10,080 kW	<b>Piers</b>	8

Substructure & Foundation			
<b>Tilt</b>	30°	<b>South facing grade</b>	0°
<b>Pipe/tubing diameter</b>	3"	<b>Soil class</b>	2 - 5
<b>Foundation type</b>	Ground screws	<b>Screw length</b>	83"
<b>Freeze thaw depth</b>		<b>Hex head set screws / Screw</b>	4

Sub array #1					
<b>Rows</b>	4	<b>Columns</b>	6	<b>Repeats</b>	1
<b>Area</b>	41' 3" (EW) × 14' 1" (NS)	<b>Rail type</b>	XR1000	<b>Diagonal bracing</b>	no
<b>E/W spacing</b>	10' 11"	<b>Rail cantilever</b>	3' 4"	<b>Pipe cantilever</b>	4' 3"
<b>Piers/repeat</b>	8	<b>Total south piers</b>	4 (3' 11")	<b>Total north piers</b>	4 (9' 2")
<b>Total cross pipes</b>	2 (41' 3")	<b>Total pipe length</b>	134' 9"		
<b>Shear</b>	1,138 lbs	<b>Moment</b>	2,845 ft-lbs	<b>Uplift</b>	-968 lbs

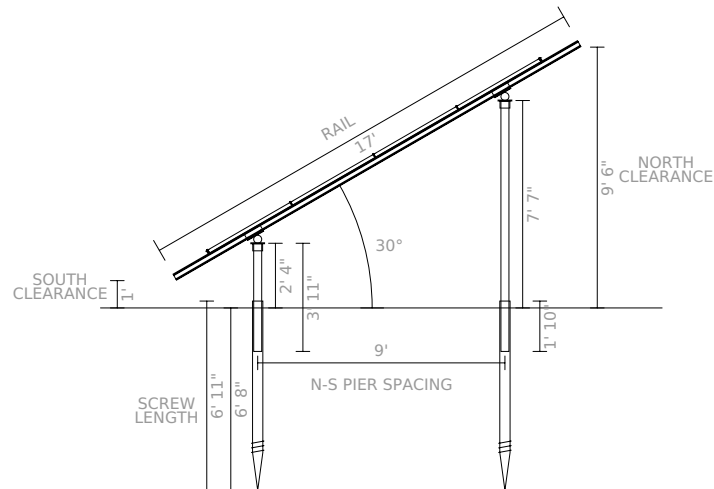
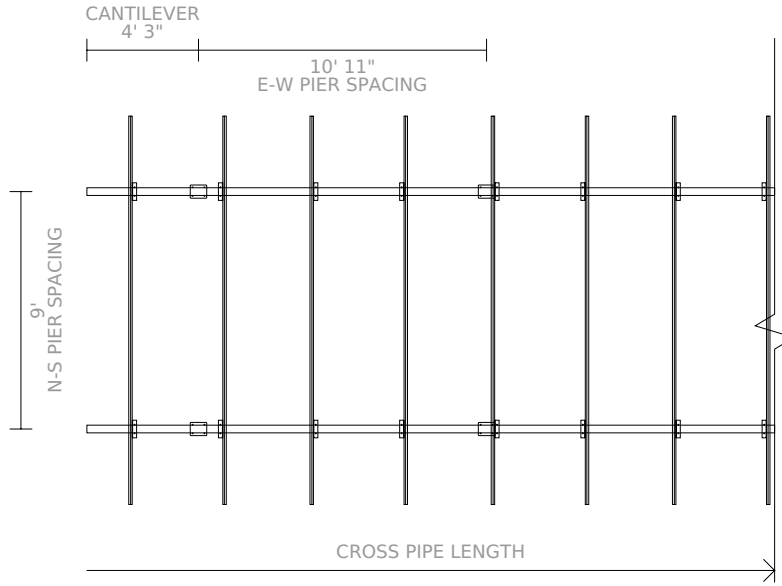

**Pipe Fitting Detail**

**XR1000 Rail**

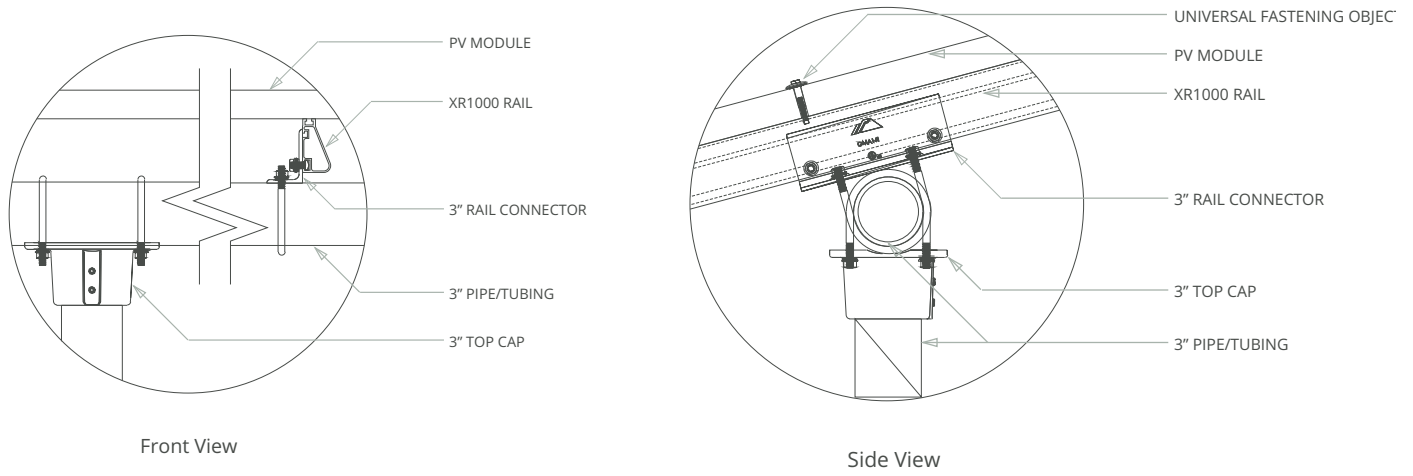

**Clamp Detail**

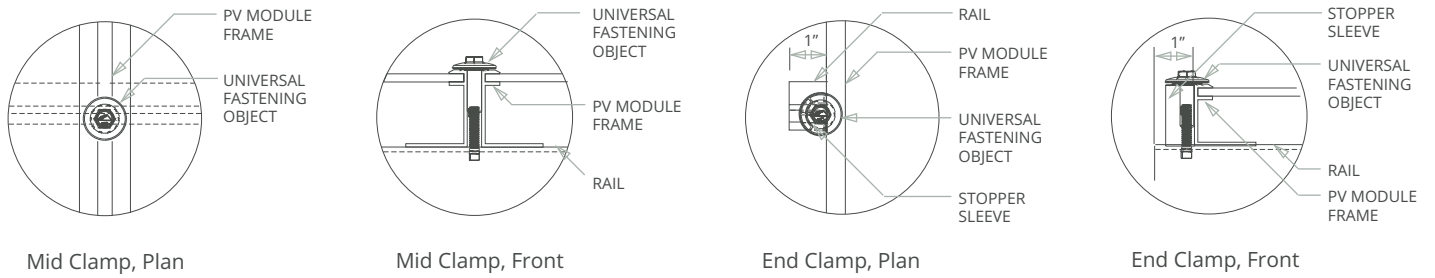



**Grounding Diagram**

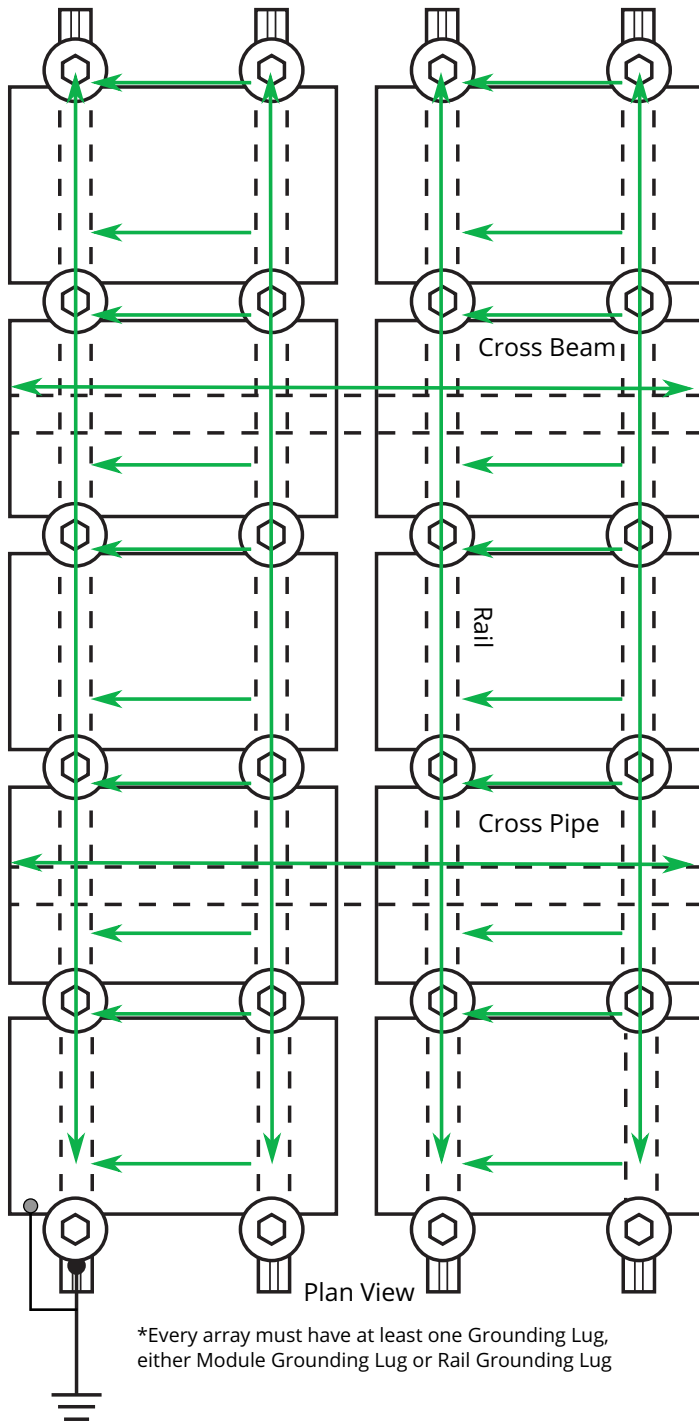

	UFO or CAMO		Rail Grounding Lug*
	Module Grounding Lug*		Fault Current Ground Path
	Bonding Point		Min 10 AWG Copper Wire

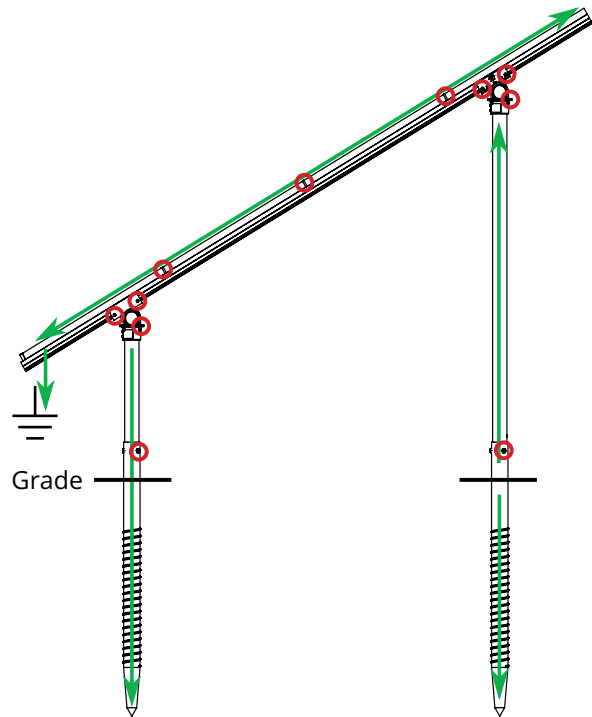

Section View

\*Grounding Lugs and wire are not required in systems using certain Enphase microinverters or certain Sunpower modules. Equipment grounding is achieved with the Engage cable for Enphase or the AC module cable system for Sunpower via their integrated EGC.

**Bill of Materials**

Part	Spares	Total Qty
<b>Rails</b>		
XR-1000-204A XR1000, Rail 204" (17 Feet) Clear	0	12
<b>Clamps &amp; Grounding</b>		
UFO-CL-01-A1 Universal Module Clamp, Clear	0	60
UFO-STP-40MM-M1 Stopper Sleeve, 40MM, Mill	0	24
XR-LUG-03-A1 Grounding Lug, Low Profile	0	1
<b>Substructure</b>		
70-0300-SGA SGA Top Cap at 3"	0	8
GM-BRC-003 Ground Mount Bonded Rail Connector - 3"	0	24
GM-HSHW-01-M1 Hex Head Set Screw	0	32
<b>Accessories</b>		
29-4000-077 Wire Clips, Molded PVC Black, Polybag 20	0	3
XR-1000-CAP Kit, End Cap XR1000 (10 sets per bag)	0	2
BHW-MI-01-A1 Microinverter/MLPE Bonding Hardware, T-Bolt	0	24